

Contributor



Construction Now Underway on New Benefis Emergency Department



A groundbreaking ceremony was held on June 12, 2017, marking the official start of the construction for the new \$12.5 million Benefis Emergency Department (ED). The size of the ED will be nearly doubled through both new construction and remodeling, and **the innovative design will allow more efficient and patient-friendly care with shorter wait times.**

Construction for the new ED will take approximately 18 months to complete. Throughout that time, the ED will remain completely functional to meet the needs of our community.

The Benefis Foundation committed to raising \$2.5 million for this state-of-the-art, patient- and family-focused center. To date, more than \$2 million has been raised.

Continued on page 2

"Our amazing donors are helping to ensure the future of world-class, life-saving emergency care for years to come."

Kevin Langkiet, Benefis Director of Emergency Services and Critical Care



Construction Phases

Phase I

Relocate helipad, surrounding parking lots, remodel old cath lab

Phase II

Remodel old endoscopy building, build new ambulance parking garage and three new trauma bays

Phase III

Build ED radiology area

Phase IV

Build critical care suites

Phase V

Remodel old ED

Phase VI

New construction in current north parking lot

The current Benefis ED was designed and built nearly two decades ago to care for only 24,000 patients annually. Today, the Benefis ED cares for more than 34,000 patients per year.

As one of only four Level II trauma centers in Montana, Benefis Emergency Services is always ready to provide life-saving care 24 hours a day, 365 days a year.

"On top of seeing patients way over the intended capacity, the complexity and acuity of the patients we're seeing is rising as well," commented Benefis Emergency Services Director Dr. Bridget Brennan. "We've flown over 1,000 Mercy Flights the last two years running, and every day we are seeing more psychiatric patients and unfortunately patients in need of sexual assault evaluations. The design team has been focused on those details plus hundreds more."

"When you think about it, the Emergency Department probably has more importance to our community and region than almost any other service provided by Benefis."

Benefis CEO John Goodnow

Several enhancements will be featured in the new ED:

- High-tech equipment and the flexibility to accommodate future technological advancements
- More than 30 rooms that will be significantly larger than the current 18 rooms
- Two pediatric suites
- Two-room sexual assault exam suite
- Behavioral health treatment room for patients facing an acute psychiatric crisis
- Enclosed ambulance garage with covered drive-through access ■

Please support the new Benefis Emergency Department and help us reach our \$2.5 million fundraising goal. You can make a gift using the enclosed giving envelope or online at www.benefisfoundation.org.

For information about naming opportunities in the new ED, please call the Benefis Foundation at (406) 455-5840.

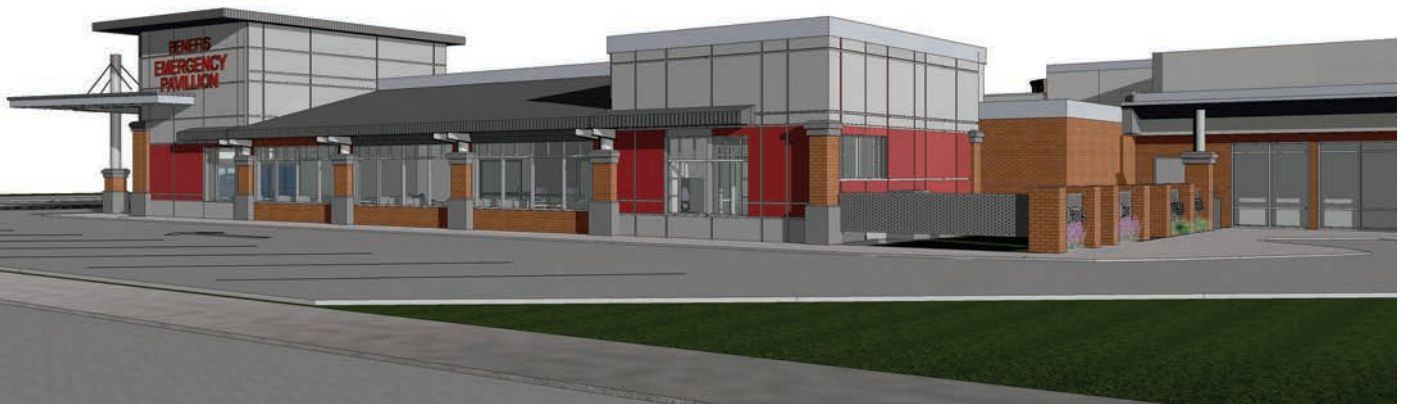

More Than \$500,000 Raised at Mayfaire

Support for Mayfaire 2017 was tremendous—more than \$527,000 was raised for the new Benefis Emergency Department capital campaign.

The charity golf tournament on May 12 at the Meadow Lark Country Club boasted beautiful weather and 60 teams. The Gala on Saturday evening had all the glitz and glam to make it an event to remember. Benefis' 125th Birthday was celebrated with an art deco theme and an exquisite three-tiered birthday cake.

More than 75 silent auction items went to the highest bidders, and the live auction featured such exclusive items as a Muhammed Ali signed boxing glove and tickets to the Country Music Awards in Nashville. The Company Men from Los Angeles dazzled guests and filled the floor with dancing.

Benefis Employees were instrumental in Mayfaire fundraising—more than 200 gave financial contributions to the ED campaign. For the list of employee donors, visit www.benefisfoundation.org.

"We are extremely grateful for the support of our sponsors, the community, and event attendees," said Mayfaire coordinator Kelly Michel. "Mayfaire 2017 was an incredible success because of their generosity and the dedication of our wonderful volunteers and committee members." ■



Mayfaire Numbers

69 business supporters

240 golfers on 60 teams

78 silent auction packages

10 live auction items

89 volunteers

36 gifts made during the special appeal

712 guests at the gala

\$3.6 million raised for improvements and special services to enhance healthcare services at Benefis over the past 18 years

Mayfaire 2017 Supporters

Paramount



**BlueCross BlueShield
of Montana**



Premier



Platinum

Contract Flooring Carpet One
Drinker Biddle

General Distributing Company
Guy Tabacco Construction Co.

Gold

Aramark Healthcare Technologies
D.A. Davidson
McLean & Associates
Moss Adams

National Laundry & Dry Cleaners
Nelson Architects
Vizient

Silver

Advanced Care Hospital of Montana
Aero Air
Allegiance Benefit Plan
Management
Anderson ZurMuehlen
Best Western Plus Heritage Inn
Brentwood Services Administrators
Central Plumbing &
Heating/Central Excavation
Centron Services
City Motor Company
Cogswell Insurance Agency
Credit Associates
Crowley Fleck
CTA Architects Engineers
Davis Business Machines
Dick Anderson Construction
Edward Jones

First Interstate Bank
Insurance Point
Junkermier, Clark, Campanella,
Stevens
Leidos Health
Maddox Roofing and Construction
Malisani, Inc.
Matsko Eye Clinic
Metro Aviation
Northern Montana Health Care
NorthWestern Energy
PathWise Partners
Rubin and Raine
Stockman Bank
Taylor Luther Group
Tri-County Mechanical & Electrical
United Materials
US Bank

In-Kind

Advanced Litho Printing
Eklund's Appliance, TV & Furniture
Forde Nursery

Fox Fine Jewelers
Thomas Cuisine

Table Supporters

Change Healthcare
Control System Integrators
Global Financial
Holman Aviation
Joseph Eve

Liberty Electric
McLaughlin Research Institute
Montana Milling
Dr. John VanGilder

Golf Supporters

Buzz Your Fuzz
Leavitt Group

Loenbro
Medline

Vemco

Corporate Supporters

McKesson Healthcare
TEKsystems

Mayfaire 2017 Donors

Albertsons
Amy's Morning Perk
Keith and Mimi Anderson
Balance Massage Therapy, LLC
Barnes & Noble Booksellers
Dudley Beard
Benefis Emergency Services
Benefis Food and
Nutritional Services
Benefis Health System
Board of Directors
Benefis Med Spa
Benefis Spectrum Medical, Inc
Benefis Volunteer Services
Big Bang Pizza
Pamalia J. Blackwell
Dr. Bill and Lynn Bloemendaal
Danny Borland and Dr. Judy Borland
William and Jacqueline Bourret
Robert and Cheryl Breckenridge
Brush Crazy
David and Casey Buckingham
Buffalo Wild Wings
Catherine L. Burnstein
Charles and Barbara Byrne
Martin and Brenda Byrnes
C'Mon Inn
Cabinet View Golf Course
David and Tanya Cameron
Candy Masterpiece
Mark and Martha Cappis
Matthew Cappis
William and Amy Carmichael
Celtic Cowboy
Cloud Catcher Aviation
Coldstone Creamery
Brittnea V. Collins
Credit Associates, Inc.
Sandra K. Cummings
Dairy Queen
Dick Anderson Construction
Scott and Christina Dimke
Disneyland Resort
Dr. Paul and Cindy Dolan
Dundas Interiors
Nancy Dusterhoff
Justin Edgar
Edward Jones
Dr. Michael D. Eisenhauer
James and Sheila Ekstedt
Electric City Coffee and Bistro
Electric City Conservatory
& Flower Farm
Grant and Mercede Eve
Ferrin's Furniture
Jim and Debbie Filipowicz
Joseph and Misty Filipowicz
Filmlites Montana LLC
Flippin Family Fun
George and Donna Franko
Brad Fridell
Todd and Karen Fried
Kent and Kathleen Funyak

Cliff Garness
Duane and Katherine Gebhardt
Sydne George
Darren and Nicole Gilcher
John H. Goodnow
Timothy and Sara Goroski
Bryce and Sara Graft
Grand Union Co., LTD.
Great Falls Symphony Association
Great Falls Trap and Skeet Club
Great Falls Voyagers
Great Harvest Bread Co
Greenup Lawn, Landscape
& Sprinklers
Rick Griffin
Robert and Veronica Griffith
Guy Tabacco Construction
Thomas and Marilyn Hall
Richard and Vicki Hammer
Patty J. Harris
Thomas and Donde Hayes
Hempl's Bakery
Nathan and Stacy Hoehn
Holman Aviation
Bruce and Patricia Houlihan
Jordan Husted and Kaci Biederstedt
Paul and Lori Husted
Indian Ridge Country Club
Jaker's
Robinette Jankiewicz
Dr. Michael and Danine Jasumback
JJ's Bakery
Nobby and Betty Johnson
John and Michelle Koppelman
David Krebs and Elizabeth Story
KRTV 3 Montana's News Station
Dr. Richard and Lorena Lauritzen
Eric and Kristy LeMay
James and Amy Linder
John Lloyd
Joe and Nancy Loncki
MacKenzie River Pizza Co
Art and Renee Malisani
Steven and Julie Mariani
Barbara Marshall
Eugene and Sanford McAllister
Dwayne McClellan
Dr. William and Juanita McGregor
McKamey Ranch Company
Meadow Lark Country Club
Mighty Mo Brewing Company
Montana ExpoPark
Montana State University
Bobcat Athletics
Dean and Cheryl Nelson
Nelson Architects
New York Life Insurance
Douglas and Paige Nicholson
North 40 Outfitters
Leslie S. Oakland
Dr. Gina M. Painter
Gary and Marilyn Parker
Parker Farms

PEAK Health & Wellness Center
 Penthouse Salon and Spa
 Perkins Family Restaurant
 Nadine Pickthorn
 Pizazz
 Lincoln and Judith Powers
 Theresa A. Preite
 ProBuild
 Pam Purdy
 Quality Life Concepts
 Vince Raine
 Susan J. Raph
 REZ Engineering
 Stacy M. Rice
 Dave and Rebecca Richards
 Roadhouse Diner
 Rocky Mountain Chocolate Factory
 Roland and Helen Lapee
 Family Foundation
 David and Karla Runkel
 Scott and Shannon Schandelson
 Scheels Sports
 Steven and Carla Schnider
 Signal Point Golf Club
 James and Jill Simmons
 Mark Simon and Dr. Jo Walker
 Margaret Sitzmann
 Amber L. Steers
 William and Dena Sterling
 Ryan and Tausha Stoll
 Adam Tabacco
 Robert and Heather Tabacco
 Greg and Trina Thayer
 The Hotel Arvon
 The Lakes Country Club
 The Ranches at Belt Creek
 The Springs Club
 The Westin Mission Hills
 Golf Resort & Spa
 Dr. Gregory and Joan Tierney
 Joseph and Leslie Tripp
 Jeff and Vicki Tuttle
 University of Great Falls
 Athletic Department
 University of Montana
 Athletic Department
 Upland Anglers Lodge and Outfitters
 Dennis and Jackie Van Heel
 Dr. John G. VanGilder
 Dr. Joe Vincent and
 Dr. Justine Redlin
 Michael and Stacy Waldenberg
 Dr. Douglas and Patrica Waldo
 Ed and Sue Warren
 Wells Fargo Foundation
 Ashley Whitney
 Dr. Tyler and Jenny Will
 Wines by Wednesday
 Tom Workman
 Frances M. Wylder



Thank you for supporting Mayfaire
 2017 and the new Benefis Emergency
 Department. Your generosity will have
 a direct impact on thousands of patients
 from our region and will allow us to
 provide the highest quality care for
 years to come.



\$10,000 Raised for the 221 Children's Fund

The 221 Children's Fund at the Benefis Foundation helps families with various healthcare expenses for children suffering from devastating illnesses.

In May, The Sting Sports Bar and 221 Industries held a special event that raised more than \$10,000 for the 221 Children's Fund. The event featured live music, silent and live auction items, and \$1 was donated for every adult beverage purchased throughout the night. A mother of a child who was assisted recently by the 221 Children's Fund expressed her gratitude, "Our family appreciates it more than you will ever know."

To date, more than 83 families have been helped by the 221 Children's Fund.

The pediatric patients from the Great Falls area that have been assisted by this fund are affected by a range of health problems, including cancer, heart and developmental problems, blindness, deafness, autism, epilepsy, cystic fibrosis, and cerebral palsy. Many require treatment or frequent follow-up appointments throughout Montana and the western United States.

The 221 Children's Fund has helped pay for travel expenses and medical bills so these children can receive the care they need. The fund also helps families with a variety of supplies and medical equipment, like wheelchair accessories, car seats, eye glasses, and more. The need for assistance from the 221 Children's Fund is always great. ■

**Please support the
221 Children's Fund
by donating today at
www.benefisfoundation.org
or by returning the
enclosed envelope to the
Foundation with your gift.**

Benefis Health System Foundation



About the 221 Children's Fund

Inspiration for this fund came from 221 Industries' Cory Smith's older brother, Tyson, who died from a rare form of cancer when he was just 13 years old. The Benefis Foundation's Angel Fund provided financial assistance to the Smith family to help with Tyson's treatments before he passed away 20 years ago.

Cory created the 221 Children's Fund with the Benefis Foundation and has held several fundraising events to support it. The name of 221 Industries was also inspired by Tyson. His lucky number was 22, and Cory's is 21.



(above) The Wench performed at the 221 Children's Fund event, which raised more than \$10,000.

(right) The Sting Sports Bar and the Hollis family donated \$1 for every adult beverage purchased at the event. Pictured (left to right): Cory Smith, Rich Hollis, Sara Hollis, and Colleen Murphy.





Donors Make MRI Scans Safer for High-Risk Patients

Thanks to the generosity of Foundation donors who gave to the Greatest Need Fund, the Benefis Radiology department recently purchased a cutting-edge vital sign monitor specifically designed to remain in the room during an MRI without being affected by the MRI magnetization.

With the Philips Invivo Expression MR400 MRI Compatible Patient Monitor, vital signs like heart rate, oxygen levels, and blood pressure are continually reviewed as patients undergo an MRI scan, which may take up to an hour and a half. This is critical for ICU patients or patients under anesthesia.

In addition to high-risk patients, this new technologically advanced MRI monitor ensures the safety of pediatric patients during an MRI scan. In order to get the clearest images, the patient must remain perfectly still for long periods of time which can be very difficult for small children and nearly impossible for infants and toddlers without the use of anesthesia.

“Our staff and physicians are incredibly happy with the results,” said Paul Fulbright, Benefis Radiology Services Manager. **“We are extremely thankful that the Benefis Foundation purchased this more than \$63,000 monitor for our department.”** ■

Typically, between five and eight patients per week need this monitor during their MRI. **That adds up to approximately 416 patients per year that are now safer because of donors like you.**

The Radiology department now has the most advanced technology available to safely produce extremely detailed diagnostic imaging for some of Benefis’ youngest and most critical patients.



Western Art Week Artist Supports Angel Fund

Countless families in Northcentral Montana have experienced the heartache of watching their child suffer from catastrophic illnesses.

Thanks to the Benefis Foundation's generous donors, **1,237 families have received assistance from the Angel Fund since 1997** to help pay for travel expenses when their children required advanced medical care at an out-of-state facility.

The Angel Fund exists to help families deal with the tremendous financial strain of caring for a seriously ill child. The children it helps have a special place in the heart of many Montanans, including renowned Billings artist Kira Fercho.

During Western Art Week in March, Kira Fercho partnered with the Angel Fund and Make-A-Wish Montana to hold a special event to benefit the two organizations. Taking place at the Celtic Cowboy in historic downtown Great Falls, Kira and several other artists displayed and sold their artwork throughout the week, donating 10 percent of their sales to the Angel Fund and Make-A-Wish Montana.



(left) A licensed clinical therapist, Kira loves working with children and is passionate about giving back to families in need. The Angel Fund requires ongoing support to continue helping children get the care they need, and these artists answered that call. Pictured: Artists Kira Fercho and Kevin Rose

The week culminated in a sold-out ticketed event on Saturday evening where guests had the exclusive last-chance opportunity to purchase artwork to benefit the two children's causes. This benefit event was sponsored and made possible by the Celtic Cowboy and Pathwise Partners, and raised more than \$1,000 for the Angel Fund. ■



If you would like to help families in our community during a time of dire need, please donate to the Angel Fund at www.benefisfoundation.org.



(middle) Thanks to Jared Brown (left) of Pathwise Partners and Wayne Thares (right) of the Celtic Cowboy for sponsoring the event.

(right) Many Benefis employees supported the event and enjoyed appetizers, beverages, and interacting with Kira. Pictured: (left) Roni Griffith, Clinic Manager, Benefis Medical Group, and (right) Betsy Yaeger, Clinic Manager, Benefis Medical Group



Photos by Cindy Cieluch Photography

Benefis Health System Foundation Board of Directors

Officers

Shannon E. Hoiland, Chair
Douglas M. Nicholson, Vice Chair
Bryce C. Graft, Secretary
Dean A. Nelson, Treasurer

Directors

Barbara L. Byrne
Grant W. Eve
Nora E. Gerrity, MD
Dena Burnham Johnson
Wayne E. Linnell
Chris R. Reiquam
James R. Simmons
Patricia T. Sletten
G. Mike Tabacco
Diane N. Volk

Benefis Health System Ex-Officio

Amy Beames, President of Senior Services, Philanthropy & Legislative Affairs
William R. McGregor, MD
Benefis Health System Board

Founding Directors

Donald H. Berdeaux, MD
J. W. Bloemendaal, MD
George L. Campanella
ThelmaRose Casey, RN*
Kevin P. Clark
John R. Corwin
James D. Eidson, MD
Gae M. Ellis*
Sandra L. Geske*
Richard L. Grieb
Gregory J. Hatley
Jane C. Hibbard*
Paul C. Husted
Richard E. Lauritzen, MD
Jack L. Lewis
Barbara L. Moe
Nancy M. O'Brien
M. Kathy Rice
Shirlee J. Thiebes
Rodney C. Thorne
Evie A. Ugrin
Al W. Verploegen
Virginia H. Wieck
Carter Williams*
Milton O. Wordal*
Frances M. Wylder

*Deceased

Richard "Dick" Doughten Retires from Benefis Foundation Board

Richard "Dick" Doughten retired recently after serving nine years on the Benefis Health System Foundation Board of Directors. Dick began on the Board in 2008 after he retired as a Ford dealership owner from Chinook. He and his wife, Nancy, moved to Great Falls to be closer to their daughter and her family and to have closer access to Benefis for his healthcare needs.

Dick was a member of the Development and Stewardship Committee, Executive Committee, Nominating Committee, and served as Board Chair from January 2012 through December 2014.

Thank you for your commitment and leadership to the Foundation Board of Directors and its mission of improving healthcare for our community and region. ■



"When the Benefis Foundation is successful, it helps the region's economy and community grow."

Jim Simmons

Benefis Foundation Welcomes New Board Member Jim Simmons

National Laundry Company has been a proud supporter of Mayfaire for the past 18 years, donating all of the table linens used at the Gala. Jim Simmons, Sales and Service Manager for National Laundry, recently stepped up his support and has become a Benefis Foundation Board Member.

Jim looks forward to being a board member and serving on the Development Committee.

"The Benefis Foundation helps contribute not only to Benefis, but to the overall Northcentral Montana medical community and population," commented Simmons.

National Laundry was founded in 1910 and has grown to own the majority of major laundry operations throughout Northwest and Central Montana. Simmons is very active with sports, and he and his family love to spend time on the water skiing, wakeboarding, surfing, and paddleboarding.

We look forward to benefitting from the hard work ethic and new ideas Jim will bring to our Board! ■

TWO TAX-WISE GIVING TOOLS

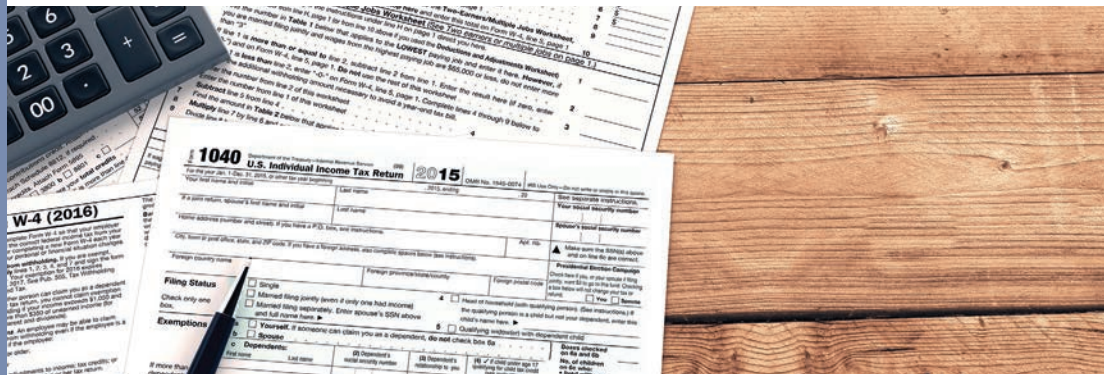

Charitable IRA Rollover

For people who are age 70½ or older, a charitable distribution from your IRA is a tax-favored way to make a gift. Amounts given in this way count toward the IRA required minimum withdrawal amount and are not subject to income tax. These gifts must be directly transferred by your IRA administrator to the charity. Contact your IRA administrator or tax advisor for more information.

Montana Endowment Tax Credit

Gifts that qualify for the Montana Endowment Tax Credit are another tax-savvy way to make charitable contributions. To learn more about this opportunity, please contact us. We make it easy for you and provide all the information needed for your tax preparation.

To learn more about tax-wise giving,
call Marilyn Parker at (406) 455-5836.



Giving monthly to Benefis Foundation provides consistent support and makes sure funds are continuously available to help those in need. Joining the Caring Hearts Monthly Giving Club is easy—your gift will automatically transfer from your bank account or credit card each month to support the fund or program of your choice.

Call us at (406) 455-5840 to find out more.

CARING HEARTS MONTHLY GIVING CLUB

Benefis Health System Foundation is grateful to the many caring donors who support our mission of improving and enhancing healthcare services in Great Falls and Northcentral Montana.

Your generosity has a direct impact on the health and well-being of families across Montana.

Donors listed gave gifts February 1 - May 31, 2017.

Gift of Life Fund & Endowment

Sara M. Branom
Rose Mary Calf Robe
Tim Coulter
Eagle Creek Colony
Jeanne M. Evans Johnson
Kenneth C. Glass
Dean and Eleanor Heydon
Ann Hofer
Karen Hollandsworth
Tom Kase and
Marsha Gummer
Julene Kennerly
Kingsbury Colony
Patricia Kinholt
Wilma Many White Horses
Ben and Alice Martin
Bonnie M. Mosbrucker
Our Savior's Lutheran Church
Paul Sebey
Kenneth and Patsy Shelhamer
Charlene Silvan
Leroy Strand Estate
Michael and Peggy Tobin
Wendy Warnick
Zeller Family Foundation

IN MEMORY OF

Fred G. Bitz
Richard and Sharon Pollington
Donald H. DeHaan
Bea DeHaan
Diane Donovan
Richard and Sharon Pollington
Delmar E. Fried
MJ and Mike Gilkerson
Carol L. Hamby
Wayne and Theo Hamby
Mildred Hicks
Joseph and Margaret Barrett
William and Roberta Campbell
Lt. Col. Donald D. Higgins
Beth Higgins
Carra A. Higgins
Michael D. Higgins
Susan C. Higgins
Duane Kohoutek
Eugene and Myrna Cady
Bette J. MacGivra
Teddy M. Branom
Brent and Kelly Michel
Gary and Marilyn Parker
Amber L. Steers

Helen L. Mavencamp
Jean and June Mavencamp
Monte W. Mavencamp
Jean and June Mavencamp
Darci M. Nelson
Terry and Marcia Talcott
Jason R. Nelson
Terry and Marcia Talcott
Audrey E. Remus
Gary and Marilyn Parker
Amber L. Steers
Robert Rinehart
Richard and Sharon Pollington
Margaret L. Sorensen
Timothy A. Sorensen
Grace E. Wiese
Family and Friends
Ed and Thelma McMaster
Anitra A. Willson
Ruda A. Marshall
Verlin and Patricia Reichelt
Vincent J. Woodwick
Greg, Sandy and
Tara Anderson
Pamela A. Buerkle
Jason, Layne, Rhea and
Lucy Hampton
Shawn, Bailey and
Riley Hampton
David and Fern Lohse
Debbie Woodwick and Family
Evelyn Young
Richard and Linda DeVries

IN HONOR OF

Jeanette Dugan
James and Jeanette Dugan
Marian A. Frost
Jean and June Mavencamp
Dr. Bryan E. Martin
Larry W. Wolfe
Kim Ramberg
Coy McHenry
Donna Stout
Melissa Balthazor

Greatest Need Fund & Endowment

AmazonSmile Foundation
Anonymous
James and Carol Auth
Wayne and Jean Blaine

Sara M. Branom
Pauline Budd and
Peggy Sullivan
Rose Mary Calf Robe
James and Jo Capp
Nels Costel
Merten and Valborg Freyholtz
Anthony Golt
Lisa Jenkins
Carl R. Kellington
Kathy J. Mangold
Ben and Alice Martin
Ethel E. Parker
Beverly Sachsenmaier
Tina St. Marks
Leroy Strand Estate

IN MEMORY OF

Richard Artz
Montana Electric
Cooperatives' Assoc
William R. Bedwell
Rose M. Bedrosian
Debra Kenney
Rita O'Connor
Donald S. Schumacher
Michael Schumacher
David E. Carlson
Joe and Linda Konesky
Willard L. Cook
Frank and Phyllis Clemens
Helen M. Cory
Nobby and Betty Johnson
Sandy DeHart
Richard and Elaine Walters
Helen E. Derks
Kenneth and Edna Palagi
LeRoy R. Fransen
Kenneth and Edna Palagi
Adam A. Hocevar
Nobby and Betty Johnson
James and Mary Larson
Velma J. Johnson
Robert and Mary Winterrowd
Joyce E. Knapstad
Kelly and Peggy Vollrath
Duane Kohoutek
Kenneth and Edna Palagi
Mildred A. Lucero
Beverly A. Koch
Arthur G. Matteucci
David and Tanya Cameron
Michael R. Mays
Ligaya P. Mays
Harold V. McCollum
US Bank

Jane R. Meyer
Lenora Dorr
Nobby and Betty Johnson
Stanley F. Meyer
Mary Milburn
John and Michelle Koppelman
Bill S. Nicholson
Kathleen M. Hodgins
Ida L. Petroff
James and Marleen Blair
Fred A. Rubino
Nobby and Betty Johnson
Jo Ann Shauer
Harlan and Patricia Orham
Nicole C. Walsh
Roberta W. Boylan
Judy A. Waring
William and Joyce Coyle
Robert F. Woodmansey
Gene and Bonnie Knight

IN HONOR OF

All Nurses Everywhere
Anonymous
Dr. Susan H. Avery
Carol Roberts
Dr. Steven J. Ayres
Earl and Linda Lenci
Benefis Oncology Unit Nurses
Dr. James A. Yturri
Benefis Sletten Cancer Institute Nurses
Ronald N. Joers
Dr. Steven M. Chrzanowski
Patricia Hosley
Stu and Janie Nicholson
Lois C. Olson
Roy and Diane Volk
Vance and Amy Weckworth
Taylor C. Forsyth
Stu and Janie Nicholson
Kris M. Green
James D. Conroy
Dr. Grant W. Harrer
Marjorie J. Olsen
Dr. Paul M. Johnson
James and Shannon Hoiland
Stacey L. Johnson
Earl and Linda Lenci
Rodney D. Keller
Earl and Linda Lenci
Nicole M. Larson
Luke and Megan Juras
Kimberly E. Manderle
Earl and Linda Lenci

Howard O. Maxwell
Tim and Billiette Coolidge
Mary Pat Maxwell
Tim and Billiette Coolidge
Erin E. Sand
Irene S. Brown
Debbie J. Schmid
Earl and Linda Lenci
Jesse L. Thompson
Earl and Linda Lenci
Dr. Jodi L. Violet
Gladys B. Barr

Peace Hospice & Endowments

Demorise and Frances Allen
James Carter
D.A. Davidson
Fraternal Order of Eagles
Great Falls Auxiliary #14
Theresa L. Gordillo
Susan Hagel
Delynn Hall
Irene M. Hodgskiss Estate
Dirk and Tamra Johnson
Mark and Juliann Johnson
Rosalie M. Kiernan
Maxwell and Garri Mauch
Jill L. Moerer
Carmen Poulsen
Don and Ping Poulsen
H. Randolph and
Dorothy Poulsen
Mark and Gerianne Poulsen
Mark Robertson
Randy and Kathy Robertson
Shirley Rothwell
Layne and Deborah Shanahan
Heather K. Spurzem
Shirley J. Stephens
Deborah Sturm
US Bank Foundation
Zeller Family Foundation

IN MEMORY OF

Andrew W. Aline
Anonymous
Theodore and Darlene Funyak
Charles A. Allen
William and Pat Barton
Kevin Entner and Family
Travis Entner and Family
Carol A. Entner-Teague
Tony Hering and Family

George and Surena Hines
Kneelon and Carol Teague
Ann Twitchell
Dorothy L. Allen
Terry and Helen Reistad
Henry and Geraldine Smith
Richard Amdahl
Clyde and Roberta Bigelow
Gary O. Bach
Joseph E. Bach
Galyn E. Gilchrist
Ronald and Patsy Long
Lillian M. Malek
John and Sharon Wichman
Joseph T. Balek
Sandra Balek
Raymond L. Beaver
Terry and Tracy Aline
Norma B. Ashby
Sherry Beaver
Irene S. Brown
Clayton and Joyce Busch
Brad and Jeanne Cochran
Sandra K. Cummings
Peggy DeBoever
Bonita G. Donohue
Beverly G. Edwards
Calvin and Charlene Eklund
Family and Friends
Sheryl L. Friden
Gene and Lynette Harada
Channing Hartelius
Cecil Y. Holland, Jr
Carl and Susan Johnson
James and Frances Kennedy
Jeffrey and Lydia Knowles
Philip and Gloria Kumm
Lager Farms, Inc.
Delmer and Beverly Mahoney
Stanley F. Meyer
Janice I. Nerem
Michael and Susan Parker
Robert and Marilyn Pimperton
Denise Puppe
Lawrence and Delores Rosin
David and Karen Rowland
Skip, Carol, Loral and
Caren Seaver
The Seifert Boys and Families
David and Shirley Shane
Sue Skees
Dr. Stephen and Lois Spencer
Jay and Lisa Stenzel
Shirley J. Stephens
Richard and Carolyn Stremcha
Marilyn Thomas
Peter and Jo Ann Thornburg
June M. Van Koten
Roy and Diane Volk
Anne F. Walker
Ardelle C. Watkins
Warren and Susan Wenz
Mark and Mary Willmarth
Janice L. Wolter

William R. Bedwell
Inez F. Bray
Laura E. Flaherty
Stephen J. Birkoski
Phyllis Birkoski
Ronald A. Bitz
Marshall and Shirley Kulbeck
Frances Ostrom
Clyde and Dianna Webster
Patti Black
Bill Black
Eddie Black
Greg Black
Wendi Kuntz
George Radovich
Fern W. Blewett
Phillip and Robin Allen
Patricia E. Ashmore
William and Jacqueline
Bourret
Jeanie N. Hanson
Robert and Lois Holter
Nobby and Betty Johnson
Mark and Patty Kohoutek
John and Marcia Leaf
Nancy A. Lewis
Debra J. Louttit
Charles and Kelly Maki
Tavie McKay and Family
Helen McLeavy
Gary and Barbara McManus
Michaela Messman
John T. Mitchell Estate
Dean and Cheryl Nelson
Cheryl L. Patton
Mary Rearden
Dale and Judy Schwanke
Dan and Helen Spurgin
Peter and Jo Ann Thornburg
Glenn and Peggy Tremper
Gayle Wadsworth
Warren and Susan Wenz
Florence M. Boysun
Randal and Susan Boysun
Rose J. Bremer
Douglas and Margie Ekegren
Adele M. Burke
Inez F. Bray
Friends of the
Adele Burke Family
James and Cheryl Hoover
Katie Huff
Mary Mathson
Lenora M. Paulson
Linda Satterly
Layne and Deborah Shanahan
William Busta
Joleen F. Gillin
Karen A. Knaup
George and Judith Knee
Patrick and Ruth McAllister
Roger and Regina Paul
Nada V. Pitt
Dr. Stephen and Lois Spencer
Dwane and Cathy Sutphin

Edwin T. Byers
Beverly A. Koch
Theresa K. Potter
David E. Carlson
Karen A. Carlson
Ronald and Sherilu Davis
Jerry and Linda Eberl
James and Shirley Edwards
Alan and Barbara Francetich
Mark and Brenda Garber
Daniel and Karen Griffin
Brian and Paula Guisti
Ronald and Judith Guisti
John and Sylvia Halko
Eddie and Cynthia Ingman
Vickie L. Johnson
Darrell and Sharon Korin
Gordon and Mary Lencioni
James and Susan Lorang
Jack and Jody Murray
Linda R. Nelson
Terry and Norene Nett
John and Jeanne Pejko
Edward and Barbara Pepos
Richard and Karen Pepos
Rodney and Julie Pribyl
Ted and Sandra Richards
Jim and Roxanne Swartz
Tractor & Equipment Co
Gertrude Coker
Marvel and Barbara Maddox
John and Delane Mayfield
David and Jeanette McMahon
Willard L. Cook
Thomas and Jane Both
W. June Cook
Helen M. Cory
Larry and Sandra Davidson
Jacqueline L. Craig
Barbara Colwell Duncan
Mary Culver
George and Mary Darragh
C. H. Cummings
Arlene M. Lee
Gary L. Darlington
Richard and Helen Thornton
James J. Dellwo
Dr. John and Nancy Henneford
Darcy L. Dengel
Judy Albin
Rich and Donna Dengel
Bessie K. Deshner
Rita A. Hudak
Edward and Karyn Jenkins
Brad and Shellie Schaefer
Marlene G. Dillard
Robert D. Dillard
Beverly J. DuBois
Gerald C. DuBois
Gary and Sharon Winchell
Helen B. Duncan
Leonard and Marguerite Dahl
Herbert Eakman
Don and Margaret Eakman
Frances Eakman

Mike and Nancy Schaeffer
Robert G. Elings
Bert and Barbara Duncan
Carl A. Erickson
Anna May Erickson
Robert and Darlene Erickson
Family and Friends
Judith E. Kinonen
Dolores Mills
Helen M. Spencer
Dan and Helen Spurgin
Dr. Stephen and Lois Spencer
Arnold E. Fischer
Gordon M. Stach
Alan E. Francetich
Theodore and Darlene Funyak
LeRoy R. Fransen
Robert D. Dillard
Loretta M. Fransen
William and Colleen Green
Mark and Leslie Hagenlock
Edward and Kathleen Murphy
Raymond J. Franz
Keith and Jeanette Bailey
Kurt and Velda Baltrusch
Frederick J. Dahlman
Gerald and Carol Ferrell
John Grizzle
Scott Hughes, Connie Franz
Hughes and Family
Marilyn G. Isringhausen
Gerald and Barbara Kakalecik
Mechanix Unlimited Inc.
Mark and Regan Meredith
John E. Miller
Gordon and Billie Jo Peterson
Stewart W. Rose
Donald and Arlene Rull
Joann K. Sutton
Joseph Zuncich
John J. Friberg
Family and Friends
Dale and Laurie Hicks
Linda Leitheiser
Dennis and Christine Tinker
Donald E. Garness
Larry and Mary Eller
Steve and Colleen Garness
Alvin and Bernice Hauser
HUB International
K & K Trucking
Dennis E. Mackey
Richard and Judy Maynard
Jerome and Kelly Parsons
W. E. Roberson
Gordon M. Stach
Marjorie B. Thomas
John C. Gihring
Inez F. Bray
Edward W. Haag
Gordon M. Stach
Ray Hanel, Jr
Maxima S. Cox
Darla K. Whitehead

Robert L. Hansen
Donald and Cherie Johnson
Richard Hanson
Michael T. Heine
Joanna Hastings
Charles and Barbara Byrne
Rocky J. Heckman
Betty Mellinger
Steve and Shellie Mellinger
Alice L. Heisel
Duane and Betty Mellinger
Wilma Heryford Fowler
Family and Friends
Fern Heryford
Russell and Lynne Heryford
Mildred Hicks
Charley and Jacalyn Frey
Adam A. Hocevar
Eric and Diane Martin
James and Sandra McKenna
Peter and Jo Ann Thornburg
Leslie R. Honrud
Terry and Roxanna Allen
Ruby I. Singer
Brad and Suzan Utterback
Charles and Glenda Worrall
Jackson The Hospice Dog
Larry and Sandra Davidson
Norma Johnson
Kurt and Kathy Jackson
Otto E. Johnson
Karl and Donna Anderson
Margaret H. Corbett
Anna May Erickson
Kurt and Kathy Jackson
Betty R. MacDonald
Kathryn Ritter
Robert and Rose Mary
Snodgrass
Raymond L. Woolf
Velma J. Johnson
Evelyn Lenton
Leroy Juneau
Demorise and Frances Allen
Harris L. Kallestad
William and Jacqueline
Bourret
Miranda Kirby
Candace Shortell
George O. Kozik
Philip and Gloria Kumm
Rose Kuntz
Amy Kline and Family
Gerald and Sylvia Waters
Donald Lehman
Laura E. Flaherty
Donald and Donna Petersen
Janette LeMaster
Family and Friends
Gail Holzheimer
Larry D. LeMaster
Bette J. MacGilvra
Karen J. LaRocque
Donald J. Mahoney
Delmer and Beverly Mahoney

Shelly K. Mahoney

Delmer and Beverly Mahoney

Eleanor F. Mares

Raymond and Claudette
Delger

Emmanuel G. Margaris

Carrie A. Ackerman
Sylvia M. Arhontes
Robert and Cara Campbell
Norvil and Avalyn Carlson
Mary Christopoulos
Richerd and Shantelle
Hutchinson
Blanche Kravik
Robert and Lucas Kravik
Robert and June Lazure
James and Peggy Malone
Jim and Dee Margaris
and Family

Howard and Mary Pat Maxwell

James and Georgia Nickle

Northwest Physicians

Jeff and Millie Platisha

Peter and Jo Ann Thornburg

Helen Viot

Bernard and Georgia Vogel

Billie B. Marn

Glen and Marilyn Enderson
Stan and Val Guedesse
Lawrence and Joyce Langford
Timothy and Linda Lewis
Elizabeth C. Ryffel

Vida L. Marquart

Randall and Patricia Carlson
Maxima S. Cox

Arthur G. Matteucci

Gerald R. Allen
Richard and Autumn Beatty
Clyde and Roberta Bigelow
William and Jacqueline
Bourret

Roberta W. Boylan

GFHS Class of 1959

Dorothy J. Hollern

Gregg and Patricia Holt

Randall and Debra Lester

Ed and Peggy Matteucci

George and Colleen McCabe

John and Peggy Munis

Michael and Susan Parker

Patrick W. Rice

Pia Schermele

Dale and Judy Schwanke

Scott, Tokerud & McCarty

Helen M. Spencer

Dr. Stephen and Lois Spencer

Gail A. Tronstad

Roy and Diane Volk

Warren and Susan Wenz

Janice L. Wolter

Gary and Nancy Zadick

Ed Matteucci

Sandra Davidson

Kota M. McManus

JoAnn L. Thornburg

Yoshiko McManus

Cathy B. Allen

Cathy Davie

Ann E. Deegan

Patricia C. Hamilton

Linda E. Harris

Laurie S. Hicks

Gale M. Kreitzberg

Dennis P. Luslin

Larry L. McManus

Renee M. Richards

Nancy K. Schieno

Kelly R. Selph

Duane Mellinger

Norris and Doris Bjork

Larry and Donna Dugas

Richard and Judy Maynard

Allan and Pamela McClain

Gary and Carol Young

Ronald C. Miller

Raymond and Claudette

Delger

Verna M. Miller

Raymond and Claudette

Delger

Ingeborg A.**Morris-Connolly**

Jeanne M. Anderson

Duane and Lois Dockter

Robert A. Kravik

Terry and Donna Kravik

Kate E. Morris

Brian and Linda Reilly

Roy and Margaret Wagner

Nina Murphy Weaver

Theodore and Darlene Funyak

Jan Nelson

Cecelia F. Eide

Laurie Glover

Montana Association

of the Deaf

Montana Registry

of Interpreters for the Deaf

Obert Family

Carole E. Sandin

JoAnn G. Newman

Ann Lynde

Melvin B. Norby

Joan Elser

Arthur and Evelyn Habel

Pearl D. Hansen

Arlene M. Kato

Gerald and Cheryl Martin

George and Colleen McCabe

Jeff and Millie Platisha

Wendy Whitehorn

Alda L. Nurmi

Sharon Howarth

Laura B. Johnson-Jewett

Beverly A. Koch

Patrick and Ruth McAllister

Shirley J. Stephens

Dwane and Cathy Sutphin

Carl F. Oja

Harold and Judith Spilde

Felix W. Parks

Dick Irvin, Inc.

Family and Friends

Gary and Rebecca Gollehon

Harvey and Holly Harris

Kronebusch Electric, Inc.

Marilyn Parks

Allan and Diane Underdal

Ronald V. Parson

Suzanne M. Parson

Ross D. Peace

Marie Bender

Myrna Peace and Family

Earl W. Peterson

Richard D. Ecklund

Mary Ann Peterson

Harry Z. Roch, DDS

Ida L. Petroff

Daniel and JoAnne Coolidge

Hank and Jacque Coolidge

Patricia Coolidge

Tim and Billiette Coolidge

Dick Irvin, Inc.

Don and Barbara Doughty

Donna H. Doughty

Tracy and Luana Dumas

Family and Friends

Mel and Lynda Fretheim

Shirley A. Furr

Gary Kiefer Farms Inc

Joe and Donna Gladeau

Frances K. Hagen

Juanita Y. Hasquet

Michael and Marlea Irvin

Byron and Rose Kluth

Diana Kluth

Lucille Knaup

Karla K. Love

Michael and Julie Martin

Gary and Barb Mercer

Ida Petroff Family

Bill and Lisette Pickens

Robert and Patsy Postma

Camille E. Seubert

Sandra K. Simons

Richard and Debra

Steinbacher

Nancy L. Tomsheck

Donna Whitt

Steven and Tracy Williamson

Marie L. Pettit

Ivan and Marlene Bauer

Maxima S. Cox

Alex and Marsha Kliene

Katheren M. Koehn

Arlene O'Day

Larry and Kathy Olson

Emily J. Seabolt

Janet A. Sirilla

The Ohio Nurses Association

Dr. Richard and Patricia Travis

Patricia Valtinson

Wendell D. Phillips

Dr. Bob and Helen Coleman

Calvin and Charlene Eklund

Marvin and Donna Korb

Robert and Deborah Kuntz

Virginia D. Landers

Edna M. Minckler

James and Georgia Nickle

Betty J. Soltesz

Jane W. Quesenberry

Norma E. Ward

Neil C. Quesenberry

Norma E. Ward

Audrey E. Remus

Rich and Joan Adams

Jim and Kim Blunn

Grant French

Carolyn J. Green

Gerry Kuntz

Mike and Joan Walsh

Mary G. Reynolds

City of Missoula,
Parks and Recreation

Raymond E. Richardson

Linda M. Van Tighem

Larry W. Roberts

Sheila M. Conlon

Family and Friends

The Johns Family

K & K Trucking

David and Marjorie Maloney

Dr. Clinton and Carrie Roberts

Fred A. Rubino

Dan and Helen Spurgin

Elma P. Ruf

Maxima S. Cox

Delroy Schmidt

David and Patricia Van Tighem

Jack Schwartz

Glenn and Joy Beard

Carl and Brenda Renalls

David D. Schwenke

Grace Schwenke

Patricia Sharp

Anonymous

Jo Ann Shauer

Glen and Marilyn Enderson

Gerald L. Smith

Rich and Donna Dengel

Irene M. Stanfield

Janet Paris and Family

Robert E. Stanfield

Douglas and Renee Mullins

Janet Paris and Family

Richard L. Stuckey

Norma E. Ward

Connie M. Tice

John and Sanna Czifro

Dale and Vickie Johnson

Patrick and Claudia O'Connell

Leslie M. Turner

Ronald and Joy Frost

Caroline G. Gillispie

Edward G. Van Tighem

Kathy Van Tighem

Gerald H. Vosberg

Virginia D. Landers

Blanch A. Wadman

Don and Shirley McDonald

Judy A. Waring

Darcy M. Birkoski

Darlene S. Braaten

Donald and Donna Petersen

Dan and Helen Spurgin

Michael L. Waring

Dan and Helen Spurgin

Raymond J. Widhalm

Brandy Hilton

Mountain View Co-op

Lauren A. Williams

Lawrence and Mary Finlayson

Adam Gray

Wendy Gray

Vivian Rambo

Peggy Yearout

Ray Williams

Beverly A. Koch

Linda Williamson

Michelle Ferguson

Brent and Kelly Michel

Richard D. Winchell

Nancy M. Lierow

Fred Winters

Sandra Larson

AnneRose Rogers

Stewart and Marilyn Rose

TC Glass Distributors

David and Patricia Van Tighem

IN HONOR OF**Dr. Kathleen S. Blair**

Laura E. Flaherty

Dr. Steven M. Chrzanowski

Richard and Elaine Walters

Stacy Clark

Debra L. Newbry

Asher R. Hinrichs

Debra L. Newbry

Jennifer N. Holmes

Laura E. Flaherty

Dr. Stacy M. Kingsland

Cloyd and Karen Grove

Randy and Trish Lynes

Andy and Gini Salvador

Nancy Rowell

Darla K. Whitehead

Dr. Thomas A. Warr

Darla K. Whitehead

Bernadette R. Whealy

Debra L. Newbry

Sletten Cancer Institute Funds & Endowments

Great Falls Gaming

Rendezvous

Lottie Hufford

Ronald N. Joers

Ben and Alice Martin

June Mavencamp
Gayle Patrick
Beverly Sachsenmaier
Scheels Sports
Leroy Strand Estate

IN MEMORY OF

Richard Artz

Pennie Nalezny

Jannell A. Christians

Delbert and Patricia
Christiaens

Betty L. Earll

Gene and Bonnie Knight

Donald E. Garness

Gene and Bonnie Knight

Duane Kohoutek

Glenn and Anna Carter
Dave and Becky Gunness
Marianne Haigh

John and Michelle Koppelman
Arthur and Elizabeth

Schroeder

Roberta G. Smith

Joseph L. Levesey, Jr

Walline M. Campbell

Ed Matteucci

Robert Matteucci

Jeffrey M. McCarty

Joe and Lauri Bauman

Ray and Patty Erickson

Harold V. McCollum

Beverly A. Koch

Foy and Judith McCollum

Gerald and Gwen Pollard

Eleanor L. Wigen

Edward S. McDunn

Clif Engebretson

Georgia Miller

David Meissner

Dr. Marcella L. Barker

Norma L. Nommensen

Gene and Bonnie Knight

Milton J. Olsen

Marjorie J. Olsen

James A. Pascal

Gene and Bonnie Knight

Claudia J. Peck

John and Linda Richter

Debbora C. Sabo

Randall and Donna Lundy

Mary E. Silvius

Larry and Mary Eloff

Blanche J. Engellant

Family and Friends

Gale and Janice Glascock

Jean L. Goldhahn
Benjamin and Marilyn Lund
Paul and Arlene Meissner
Joseph Moline and
Renita Lucy-Moline
Thoralf and Patricia Moline

Karen A. Phillips

Joan E. Quigley

William Silvius

Margaret L. Sorensen

Timothy A. Sorensen

Carolyn W. Titus

Adam and Eleanor Carroll

Robert D. Watson

Mary E. Baird

David and Valorie Snapp

Charles and Mary Yaeger

Delores White

Dale and Judy Schwanke

Edward and Joy Skubitz

Naida, Eric and Mark

Williams and Family

Raymond J. Widhalm

Antoinette Dempsey

Tom and Josephine Dempsey

Vincent J. Woodwick

Debbie Woodwick and Family

IN HONOR OF

Daryl T. Ries

Dr. William and Juanita

McGregor

Kristal Ries McHugh

Lynn K. Shanks

Robert and Lynn Shanks

All Other Funds & Endowments

Aero Air

Michael Alberson

Mike and Tamra Anderegg

Roselyn Azure

Dr. Jeffrey and Wendy Baker

Kurt and Velda Baltrusch

Amy D. Beames

Robert and Sydney Blair

Pete and Anna Bleskin

Mary Lou Delaire

Kira Fercho

Mark Finnicum

First Interstate

BancSystem Foundation

Robert and Jennifer

Frederiksen

Barry and Lacey Gallagher
Brian W. Geike
Thomas and Dr. Nora Gerrity
Wells and Rebekah Giles
Great Falls Emergency
Services, Inc

Corrina Guardipee-Hall

Mark Hawn

Karen Hollandsworth

Robert and Lois Holter

Dr. Donald and Kay Jelinek

Jody Johnson

Lisa Kacvinsky

Alex and Marsha Kliene

L'Heureux Page Werner

Colin and Jaci Lee

Don and Elizabeth Lidstone

Lyla J. Lords

Christopher and Courtney

Lowen

Donald and Beverly McKamey

Neal and Mary Jane Mishler

William and Connie Morris

Sharon E. Mueller

Kenneth and Cindy Munski

New York Life Insurance

NorthWestern Energy

Robert and Gladycy Oakland

Scott and Sheila Patera

Pete's Auto Sales, Inc.

Sheila M. Rice

William and Joanne Salina

Russell and Linda Say

Janet Schemm

Mark Simon and Dr. Jo Walker

John Sodergren

State of Montana

Bernadette A. Stock

Takes Horse Gallery

Jeff and Karolina Tierney

James M. & Frances M.

Wylder Foundation

IN MEMORY OF

Ernest I. Bahnmiller

Steve and Michelle Bahnmiller

Family and Friends

Helen Y. Richter

Dean and Joyce Robertson

Charlene Silvan

Ronald A. Bitz

Russ and Terry Hanson

David Hill and

Lauren Cress Hill

Fern W. Blewett

Don and Susan Hamilton

John D. Brunzell

Gregg and Patricia Holt

Gary L. Darlington

Lynnette K. Cook

Keith and Patti Jo Danreuther

Marlys Edmonds

Sandy Jappe

Darla Kaercher

Claire L. Marty

Monte and Dede Reichelt

Verlin and Patricia Reichelt

Charlene Silvan

Marilyn A. Swanson

Dianna M. Webster

Regina A. Davis

William and Linda Booth

Lillian M. DeBerti

William and Linda Booth

James J. Dellwo

Norman and Judy Kamrud

Edwin and Barbara Moore

Stanley and Mary Rathman

Curtis and Mary Ann Ries

Darcy L. Dengel

Rich and Donna Dengel

Mary Fry Davis

Ronda V. Anderson

Anonymous

Jim and Kim Blunn

Pamela D. Crisp

Sharon F. Dieziger

Janet M. Leishman-Donahue

Howard and Mary Pat Maxwell

Terry and Paula Olinger

M. Dayle Perrin

Elaine K. Schuchard

Teresa Shiner

Corinne Squires

Susan K. Tonne

Kelly and Peggy Vollrath

Rita M. Grasseschi

Daniel and Teresa Aakre

Adam A. Hocevar

Harlan and Patricia Orham

Ellen J. Hockett

Dennis and Carroll Weir

Dawn S. Holt

Gregg and Patricia Holt

Arthur G. Matteucci

Chris and Cindy Reiquam

Jessica M. McCurdy

HUB International

Cecil O. Murphy, Jr

Norris and Doris Bjork

Maryann O'Connor

Barbara W. Brodock

Audrey E. Remus

Judy L. Doheny

Family and Friends

Terry and Janet Haughian

Brent and Kelly Michel

Shelley C. Rossberg

Karen Rowell

Beverly Townsend

Dennis and Carroll Weir

Jo Ann Woods

Mary E. Silvius

Richard and Marlene Protsman

Timothy D. Westphal

Alan and Karen Lippert

IN HONOR OF

Benefis Intensive Care Unit Nurses

Clyde and Roberta Bigelow

Benefis Cardiology Unit Nurses

Clyde and Roberta Bigelow

Dr. Bradford A. Bergman

Richard C. Bennett

Mary E. Bryant

Dr. Michael D. Eisenhauer

Earl and Linda Lenci

Dr. Eve M. Gerasimou

Ed and Peggy Matteucci

Dr. W. Lea Gorsuch

Paul C. Husted

Jaimee J. Gregoire

Michael and Sarah Zook

Dr. Grant W. Harrer

Albert and Gloria Fey

Quinne I. Kellam

Michael and Lindsey Kellam

Joe Knox

Alan and Karen Lippert

Renee M. Lance

Earl and Linda Lenci

Mercy Flight Crew

Alan and Karen Lippert

Carrie A. Powell, FNP

Jean Peres

Nicole Ramstead

John and Sandy Ramstead

Megan E. Schermele

Pia Schermele

Cory Smith

Elaine M. Balzer

Roy and Diane Volk

Dick and Nancy Doughten

Nobby and Betty Johnson

Dr. James A. Yturri

Richard C. Bennett

Our donors deserve proper recognition for their generosity. If your name is listed incorrectly, please contact us and allow us to apologize and correct our records: (406) 455-5840 or by email, foundation@benefis.org.

Thank you for supporting Benefis Foundation!

Contributor



GENEROSITY HEALS

Non-Profit Org
US Postage
PAID
Permit 129
Great Falls, MT

A publication of

Benefis Health System Foundation
PO Box 7008
Great Falls, MT 59406-7008
1101 26th Street South
(406) 455-5840
benefisfoundation.org



facebook.com/benefisfoundation

To receive an electronic version of Contributor and/or our monthly electronic newsletter, please send an email to foundation@benefis.org.

ADDRESS SERVICE REQUESTED

Please check any that apply and mail back to us.

- Note address correction.
- I am receiving duplicate newsletters.
(Please include your correct address.)
- Please remove my name from the Contributor mailing list.

Introducing Mega Code Kelly

New Training Manikin Enables Real-Life Simulations

Benefis Health System is excited to offer a new, technologically advanced training manikin called Mega Code Kelly for employees to practice and perfect a wide range of advanced life-saving skills. The Benefis Foundation was able to make this purchase for the Organizational Development Department because of the generosity of Greatest Need Fund donors.



“Employees light up when they discover how realistic Mega Code Kelly is.”

Jan Leishman-Donahue,
Benefis Organizational
Development Manager

This life-size manikin boasts thousands of impressive capabilities, including the opportunity to listen to sounds of the heart and lungs with a stethoscope, more than 1,400 electrocardiogram (heartbeat) rhythms, and an instructor-controlled blood pressure arm for realistic palpation.

Benefis employees across the entire health system can now use this state-of-the-art manikin to practice multiple procedures, including starting IVs, catheters, and drains. Instructors can manipulate the settings on Mega Code Kelly so employees have to react to changes in the vital signs, like pulse, respiration, and heart rate, to diagnose the patient.

“Training on this manikin helps our employees become competent and confident faster than traditional instruction, and our employees love being able to train in a hands-on way,” said Leishman-Donahue.

All medical and care giving departments at Benefis have access to work and train with Mega Code Kelly. This training manikin helps with clinical decision making skills and has applications for all provider skill levels, from newer grads to experienced employees. ■

The Foundation’s Greatest Need Fund allows for purchases like this that directly improve patient care and help ensure the best patient outcomes. Please donate today to this fund using the enclosed giving envelope, or by visiting www.benefisfoundation.org.